

NANCY HOWARD
DEED BOOK 201
PAGE 200



0300.5

COUNTY ROAD

1.99 ACRES

This is to certify that on September 23, 1982, I surveyed the property shown on this plat, known as the Property of Alvin C. and Martha W. Howard, recorded in the RMC Office of Greenville County in Plat Book WW on page 181, and that the property lines, walls and buildings are as shown hereon; that the building located on said lot does not encroach or project on adjacent streets or property, and that no adjacent walls or buildings encroach or project on said premises and that no utility lines cross this property except as shown hereon. This property is not located in a designated flood hazard area.

James R. Freeland
James R. Freeland PLS & PE 4781

063 0223 3 0109

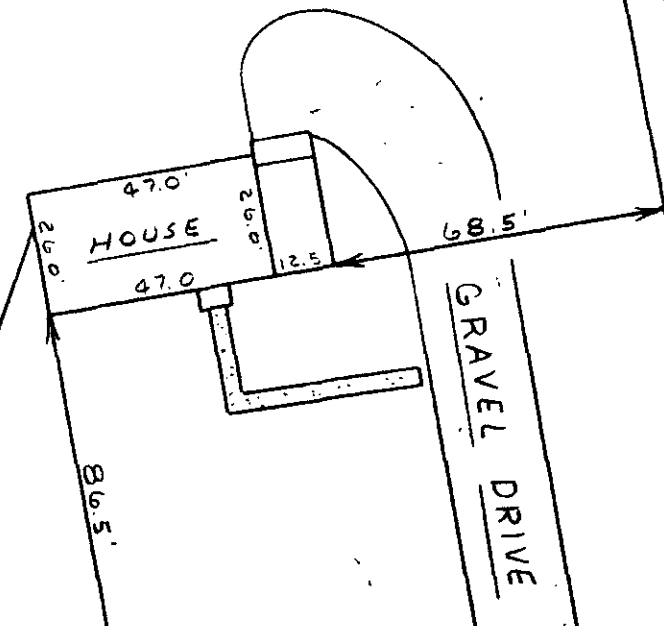

FILED
GREENVILLE CO. S.C.
SEP 27 3 18 PM '82
DONNIE S. TANKERSLEY
R.M.C.

7529
9-D-88

99.0'
N 64° 15' E
HAMMETT

HAMMETTS BRIDGE ROAD

N 51° 45' E

255.0'

31.3'
N 25° 15' E

REF. I.O.C 25'



STATE OF SOUTH CAROLINA
GREENVILLE COUNTY
SURVEY FOR
LARRY A. HOWARD
CYNTHIA V. HOWARD

FREELAND & ASSOCIATES Engineers • Land Surveyors	
GREENVILLE, S.C.	
SURVEY	FL
DRAWN	MC
CHECK	M.C.
SCALE	1" = 40'
DATE	9-23-82
DWG. NO.	82-7885

SEP 27 1982

534.2-1-10.1

MICROFILMED